

system41



GENIUS products feature
PHIFER WIRE PRODUCTS INC.

41 mm RETRACTABLE INSECT SCREEN

Genius produces a series of different sizes and designs of Cassette Roller Insect Screen Systems, developed to suit different design requirements and to meet the needs of demanding markets worldwide.

All the systems have their own distinctive cassette style and combine with a number of interchangeable profiles to create a unique series of retractable screening solutions.

Providing innovative long lasting designs, as a result of studious efforts to optimise performance and efficiency, **Genius** Retractable Insect Screens are made from fine micro-extruded aluminium profiles combined with durable nylon accessories and the high quality weatherproof fibreglass mesh from Phifer Wire Products Inc. And now, every **Genius** retractable system features the optional Brake for use in both vertical and horizontal applications.

The systems are supplied in convenient bar lengths, according to the profile, of 4.7 mtrs (185") 5 mtrs (197") or 6 mtrs (236"). This allows the fullest optimisation of the system with the minimum of waste.

Guide profiles feature pre-inserted brushpile and the cassette is pre-assembled and complete with mesh fixed to a centre tube and sliding bar.

The major part of preparation is made with one simple cut through the cassette and with simple square cuts to the guides, you have cassette, tube, screen and guides neatly cut for immediate installation. Some systems are also supplied as pre-assembled modules adaptable to the required dimensions and complete with all the accessories.

Genius Retractable Insect Screen systems are able to be installed on windows and doors, either inside the opening or front fixed, and the appropriate accessory kits include all the components necessary for the different mounting options.

Despite the simplicity of the systems, there are enough options to allow flexibility of choice and quick installation on almost any type of existing frame – providing solutions for both residential and commercial applications.

Each **Genius** system can be made in a number of window screen configurations or door screens simply by changing the accessories but using the same cassette and inter-changeable guides. Our individual technical data sheets show the combinations and options available in each system.

Compare the versatility and quality with other systems on the market and you will see the difference.

Only first quality materials are used to make **Genius** Retractable Insect Screen Systems, so whichever system you install, you know you will get the same high standard of quality and reliability.

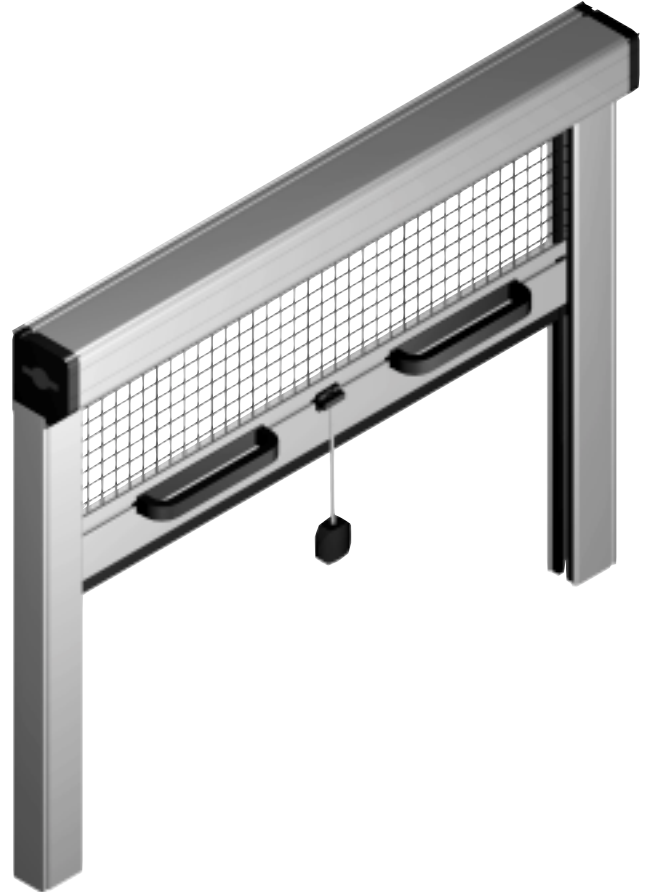

COLOURS AVAILABLE

Anodized Silver	0030	White	RAL 1013
Bronze	0040	Black	RAL 9005
White	RAL 9010	Brown	RAL 8014

Please, check the above colours on a RAL palette.

Above listed data may change without notice.

Genius®

www.geniusnetwork.biz

system41

SUGGESTIONS

VERTICAL SYSTEM - SPRING LOADED (INSET FIX)

Maximum sizes recommended:

We suggest not to exceed the following sizes:

- 180 cm width x 170 cm height for cassettes in the System 41 series
- 180 cm width x 230 cm height for cassettes in the System 41 series

Standard mesh and alternative screens:

System 41 is normally supplied with fibreglass mesh.

However there are some optional black-outs and shade screens available.

We suggest to use the short spring for openings not wider than 70 cm.

Spring loading (clockwise)

	WIDTH 50/60 cm	WIDTH 60/80 cm	WIDTH 80/180 cm
HEIGHT 40/170 cm	short spring 8/10 turns	short spring 8/10 turns	long spring 20/24 turns
HEIGHT 170/230 cm	/	short spring 8/10 turns	long spring 25/27 turns

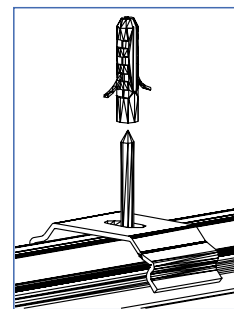
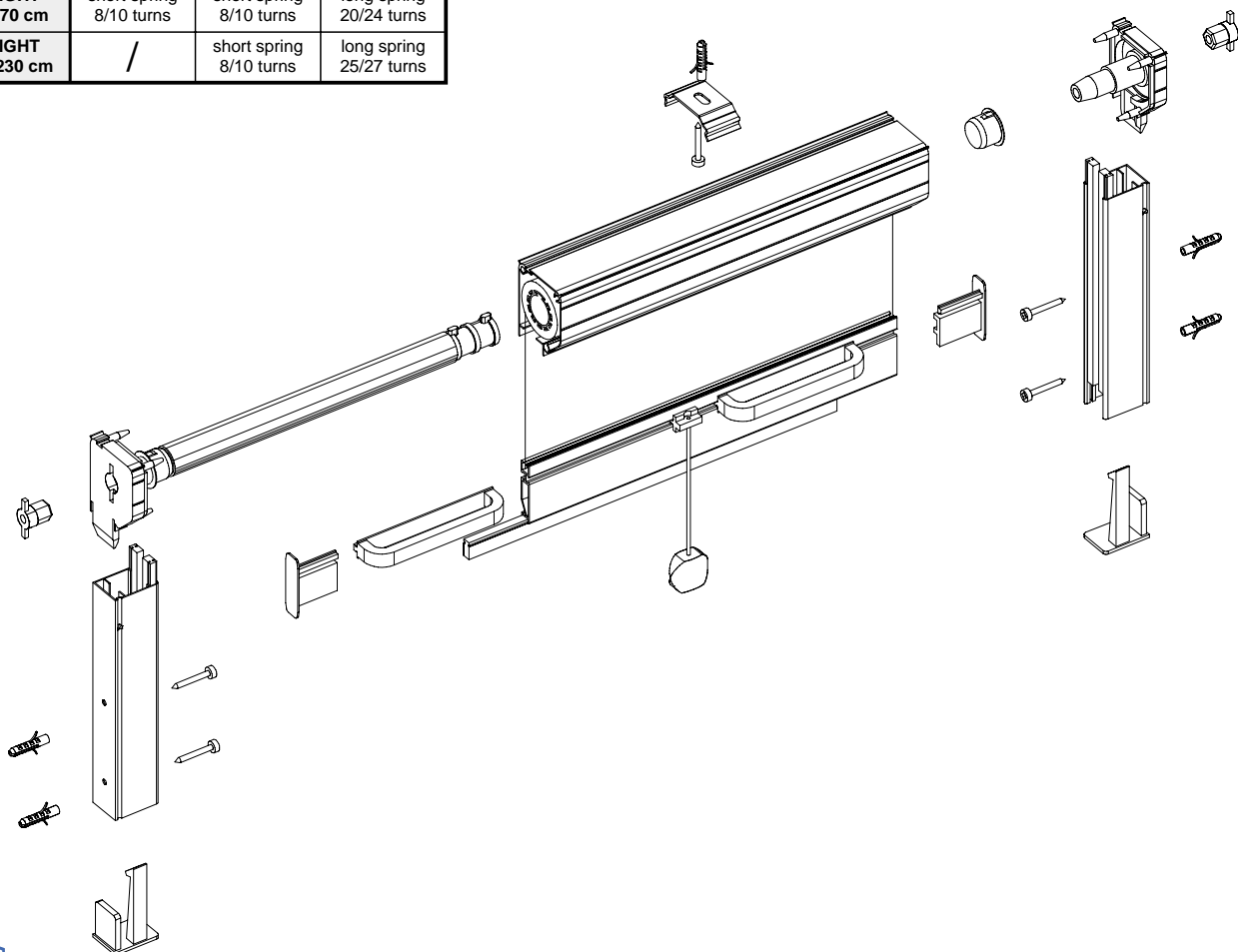

We suggest to use the fixing bracket in case of inset mounting in order to give more stability to the cassette.

S.T. Syst41 VertMoi Luce ING V.1.0 0802 • PDF

CUTTING SPECIFICATIONS

cassette

cassette with tube,
mesh and sliding bar: = opening width **minus** 19 mm **1 Pc.**

guides

side guides 30x22 mm: = opening height **minus** 54 mm **2 Pcs.**

Genius[®]

www.geniusnetwork.biz

system41

SUGGESTIONS

VERTICAL SYSTEM - SPRING LOADED (FRONT FIX)

Maximum sizes recommended:

We suggest not to exceed the following sizes:

- 170 cm width x 165 cm height for cassettes in the System 41 series
- 170 cm width x 230 cm height for cassettes in the System 41 series

Standard mesh and alternative screens:

System 41 is normally supplied with fibreglass mesh.

However there are some optional black-outs and shade screens available.

We suggest to use the short spring for openings not wider than 70 cm.

Spring loading (clockwise)

	WIDTH 50/60 cm	WIDTH 60/80 cm	WIDTH 80/170 cm
HEIGHT 40/165 cm	short spring 8/10 turns	short spring 8/10 turns	long spring 20/24 turns
HEIGHT 165/230 cm	/	short spring 8/10 turns	long spring 25/27 turns

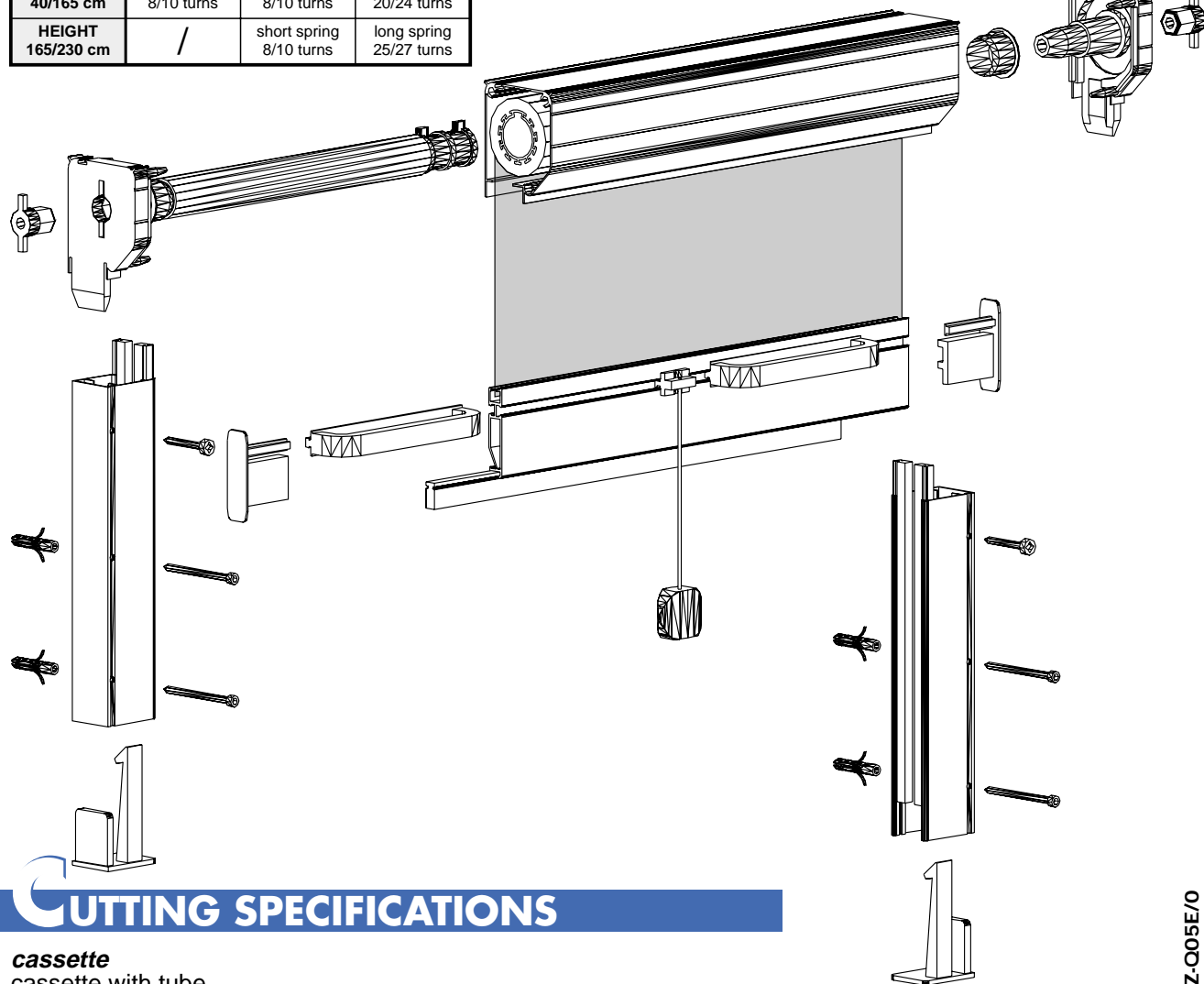

In the drawing above is shown how to fix the end cap into the guide by using the little screw.

S.T. Syst41 VertMoll Front ING V.1.0 0802 • PDF

CUTTING SPECIFICATIONS

cassette

cassette with tube,
mesh and sliding bar: = opening width **plus 42 mm**

1 Pc.

guides

side guides 30x22 mm: = opening height **plus 46 mm**

2 Pcs.

Genius®

www.geniusnetwork.biz

system41

VERTICAL SYSTEM - CHAIN DRIVEN

(INSET FIX)

Maximum sizes recommended:

We suggest not to exceed the following sizes:

- 160 cm width x 170 cm height for cassettes in the System 41 series
- 160 cm width x 230 cm height for cassettes in the System 41 series

Standard mesh and alternative screens:

System 41 is normally supplied with fibreglass mesh.

However there are some optional black-outs and shade screens available.

We suggest to use the ballast profile code 01-20040-0-5 (to assist fall of the screen)

Note:

For the chain driven system use the guides 40x22 mm (01-02000-X-X).

Spring loading
(clockwise)

	WIDTH 80/160 cm
HEIGHT up to 170 cm	long spring 3/4 turns
HEIGHT up to 230 cm	long spring 3/4 turns

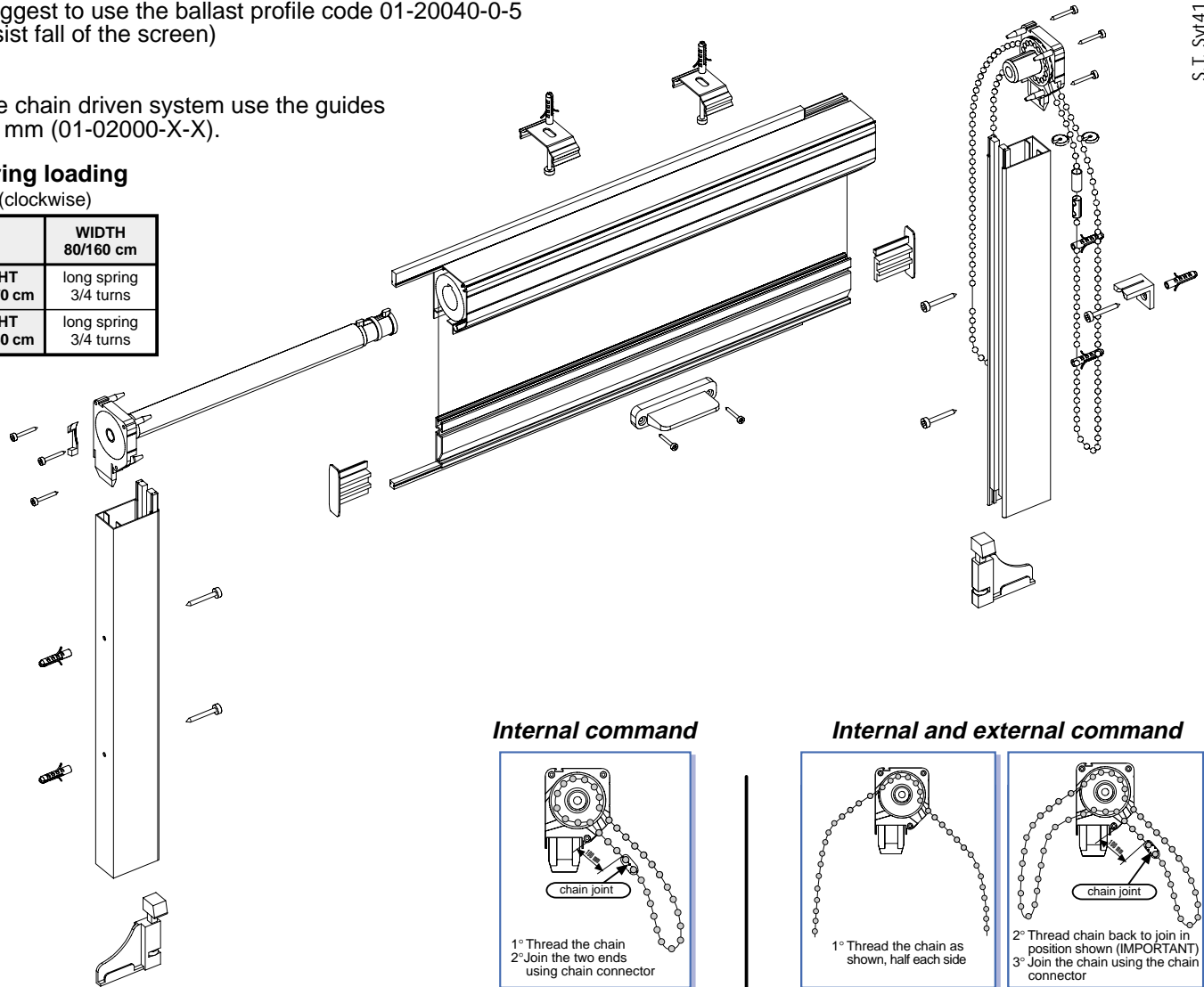

Internal command

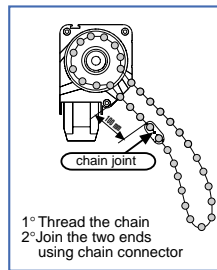

Internal and external command

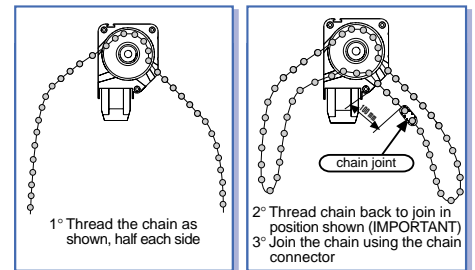

CUTTING SPECIFICATIONS

cassette

cassette with tube,
mesh and sliding bar: = opening width minus 25 mm **1 Pc.**

guides

side guides 40x22 mm: = opening height minus 54 mm **2 Pcs.**

Genius[®]

www.geniusnetwork.biz

system41

OPTION FOR
FRONT FIX

SINGLE HORIZONTAL (DOOR) SYSTEM (INSET AND FRONT FIX)

Maximum sizes recommended:

We suggest not to exceed the size of 120 cm width
(170 cm for extra-wide version)
x 250 cm height for cassettes
in the System 41 series.

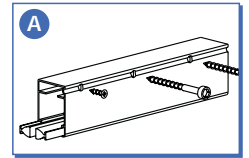
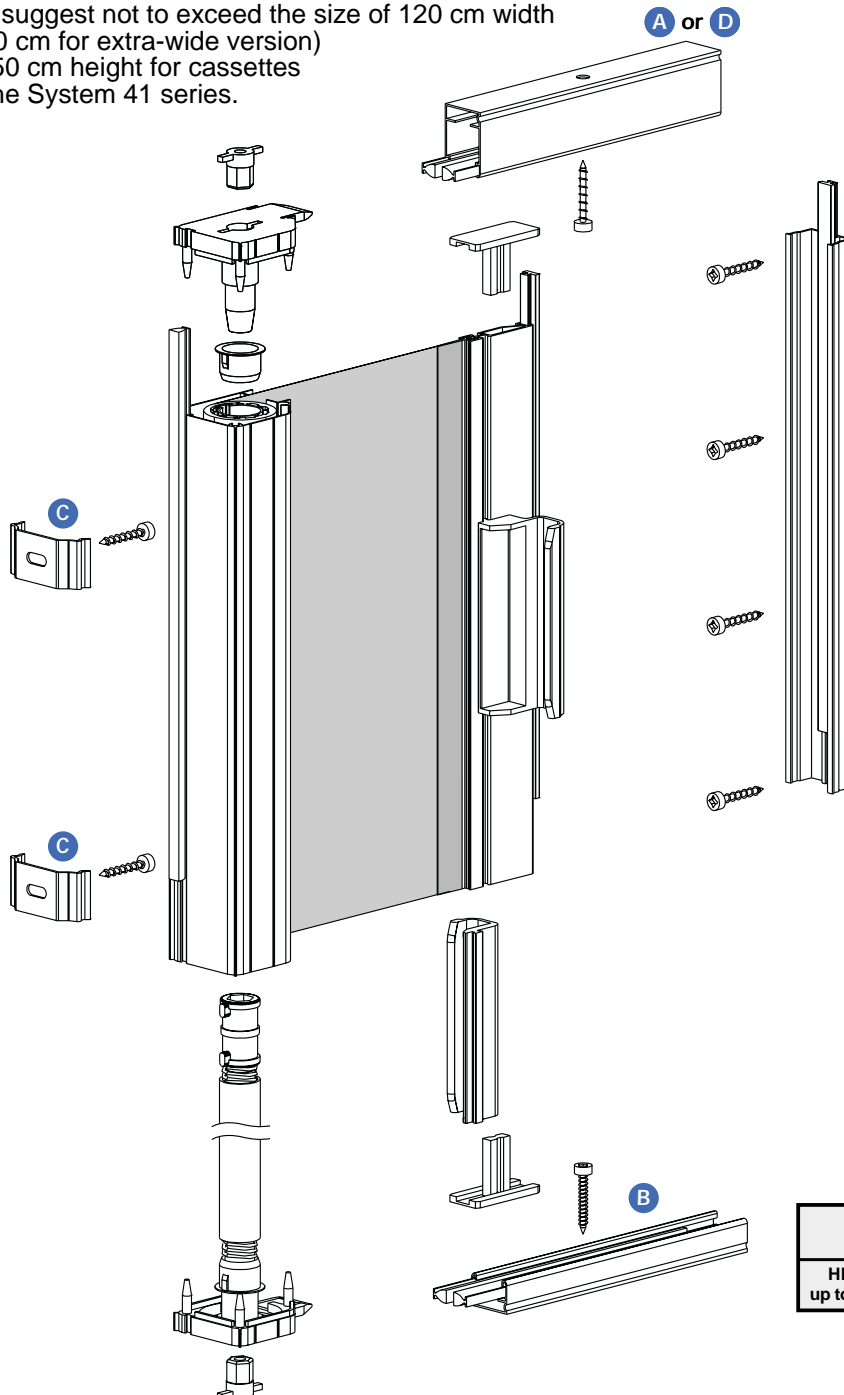

Option for front fix
(single & double)

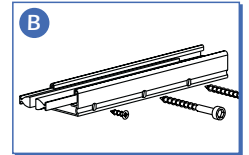

Option for front fix
(single & double)

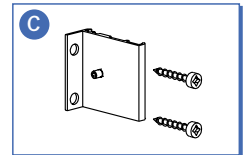

Option for front fix
(single & double)

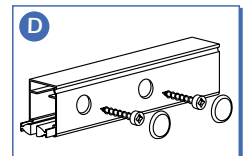

Option for front fix
with cap
(single & double)

Spring loading (clockwise)

	WIDTH up to 120 cm	WIDTH extra wide up to 170 cm
HEIGHT up to 250 cm	door spring 14/16 turns	extra long spring 25/27 turns

CUTTING SPECIFICATIONS

cassette

cassette with tube,
mesh and sliding bar: = opening height **minus** 19 mm

1 Pc.

guides

top and bottom guides 40x22 mm
and 22x22 mm: = opening width **minus** 54 mm

2 Pcs.

U-profile + magnet

U-profile: = opening height **exact**

1 Pc.

Above listed data may change without notice.

Genius®

www.geniusnetwork.biz

S.T. Syst41 OrizzSing LuceFront ING V.1.0 0802 • PDF

GCZ-Q07E/O

system41



OPTION

SINGLE HORIZONTAL (DOOR) SYSTEM (INSET FIX)

Maximum sizes recommended:

We suggest not to exceed the size of 170 cm width x 250 cm height for cassettes in the System 41 series.

Note:

To create the Smooth Upgrade add to the standard single horizontal system the additional accessory kit (01-26140-0-X).

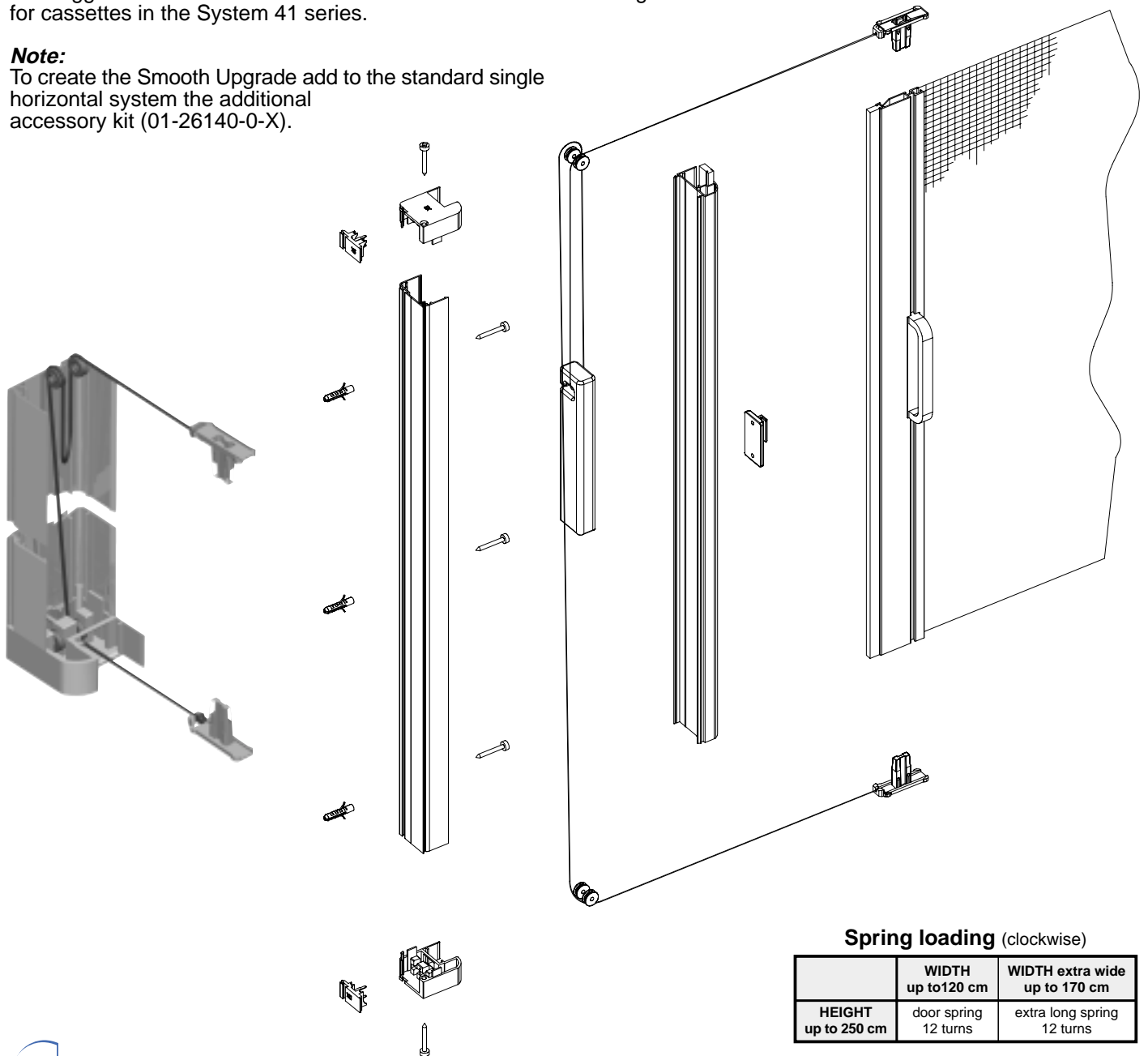

Spring loading (clockwise)

	WIDTH up to 120 cm	WIDTH extra wide up to 170 cm
HEIGHT up to 250 cm	door spring 12 turns	extra long spring 12 turns

S.T. Syt41 OrizzSing Luce opsMT ING V.1.0 0802 • PDF

CUTTING SPECIFICATIONS

cassette

cassette with tube,
mesh and sliding bar: = opening height **minus** 19 mm **1 Pc.**

guides

top and bottom
guides 30x22 mm: = opening width **minus** 85 mm **2 Pcs.**

Smooth Upgrade Option

U-profile: = opening height **minus** 31 mm **1 Pc.**

cover profile: = opening height **minus** 31 mm **1 Pc.**

Genius®

www.geniusnetwork.biz

system41

OPTION FOR
FRONT FIX

DOUBLE HORIZONTAL (TWIN DOOR) SYSTEM (INSET AND FRONT FIX)

Maximum sizes recommended:

We suggest not to exceed the size of 250 cm width x 250 cm height for cassettes in the System 41 series.

Spring loading (clockwise)

	WIDTH up to 250 cm
HEIGHT up to 250 cm	door spring 14/16 turns

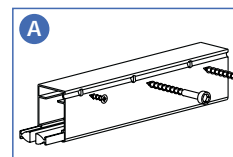
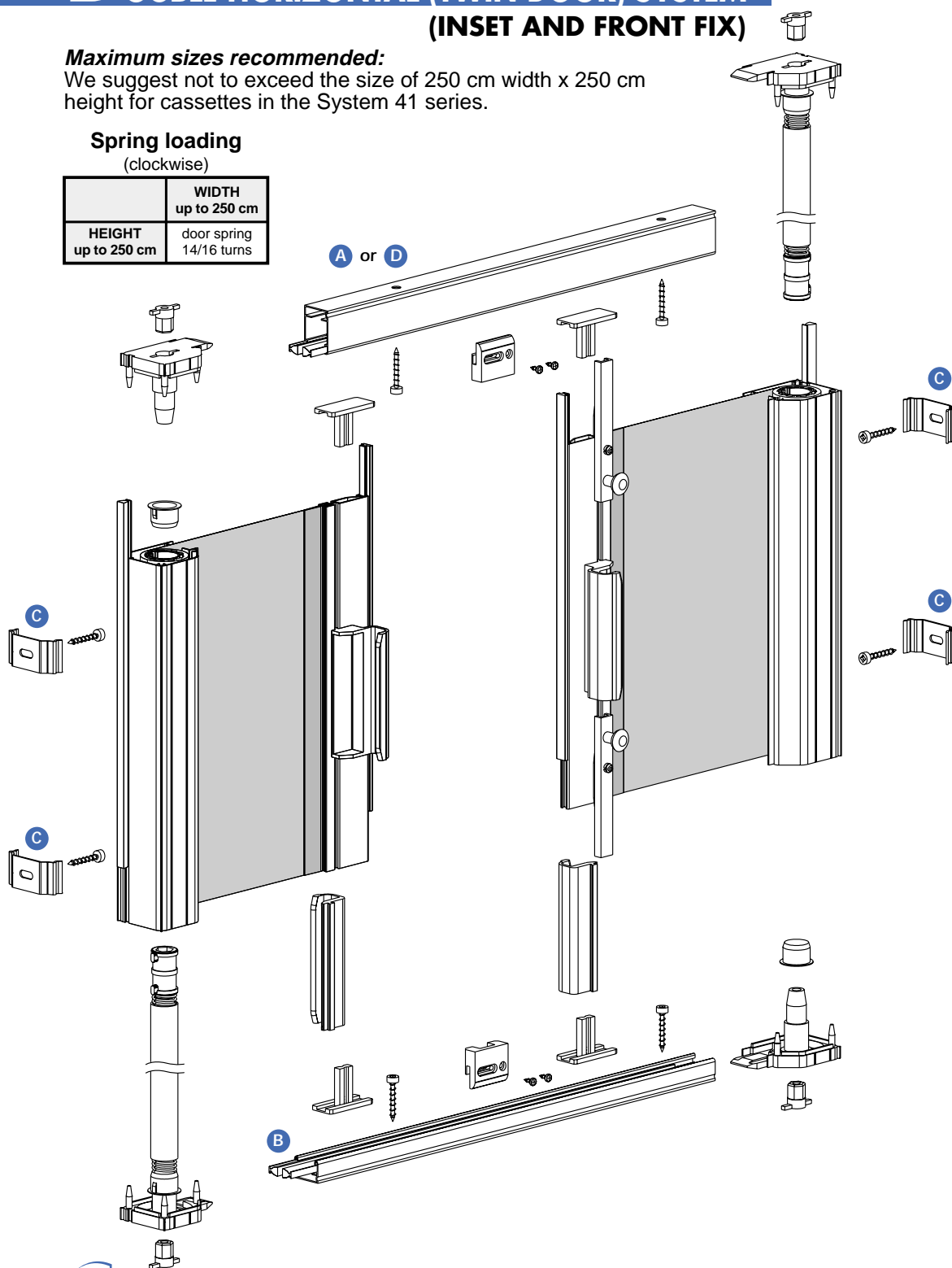

Option for front fix
(single & double)

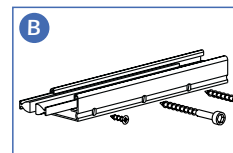

Option for front fix
(single & double)

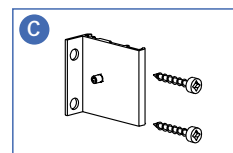

Option for front fix
(single & double)

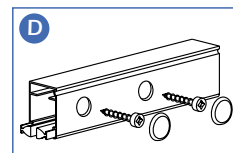

Option for front fix
with cap
(single & double)

S.T. - Syst41 OrizzDopp LuceFront ING V.1.0 0802 • PDF

CUTTING SPECIFICATIONS

cassette

cassette with tube,
mesh and sliding bar: = opening height **minus** 19 mm **2 Pcs.**

guides

top and bottom guides 30x22 mm and 22x22 mm:
= opening width **minus** 104 mm (can be divided in two) **2 or 4 Pcs.**

Above listed data may change without notice.

Genius®

www.geniusnetwork.biz

GCZ-Q09E/0

system41

P PROFILES AND SIZES

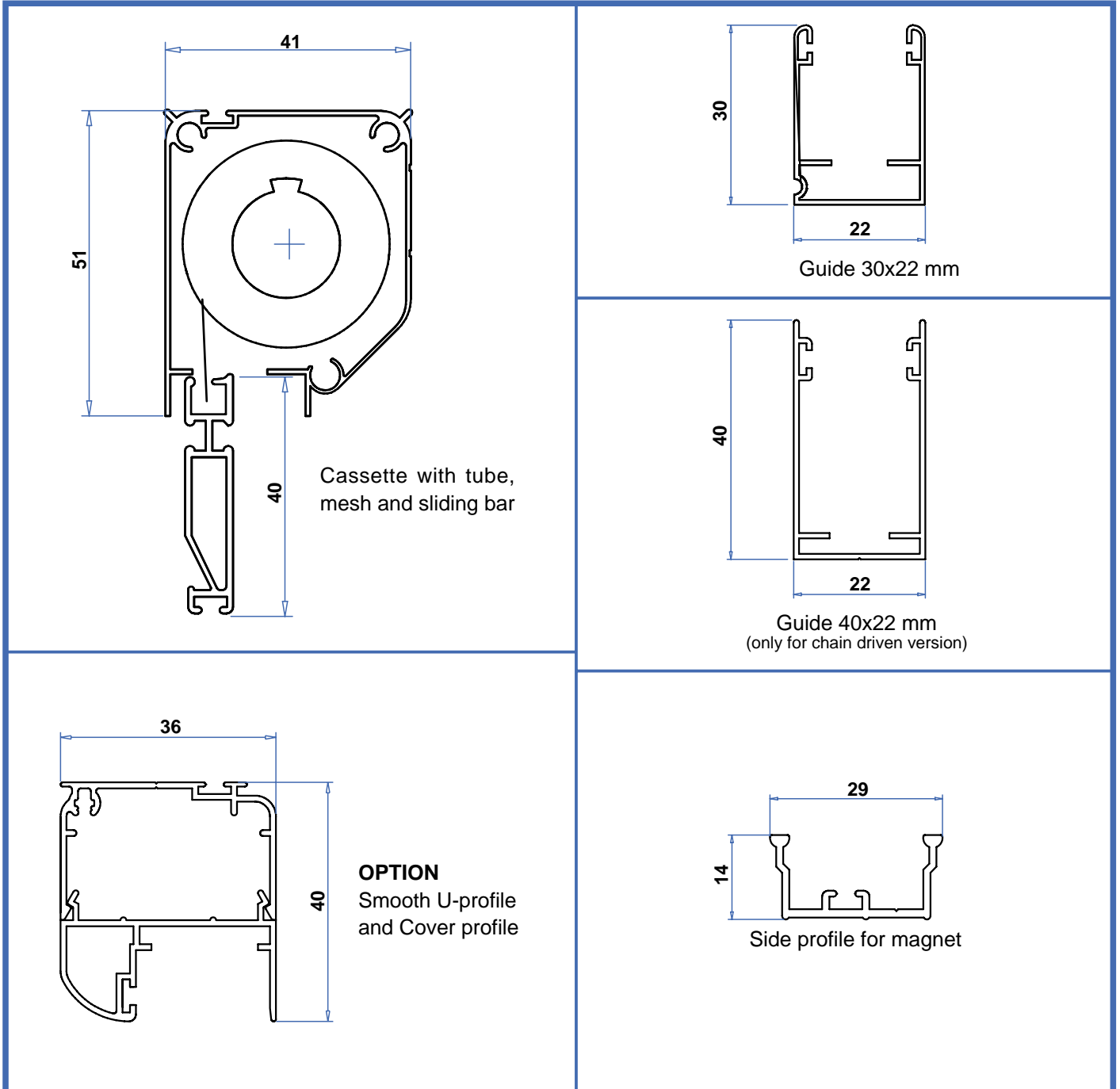

For U.S.A. see conversion table mm-inches

Genius[®]

www.geniusnetwork.biz

system41

**USER-FRIENDLY
AND FUNCTIONAL**

41 mm RETRACTABLE INSECT SCREEN

VERTICAL (WINDOW)

The accessory kit includes all necessary components to assemble a vertical (pull-down) system 41 roller insect screen either as inset mounted or front mounted system.



GENIUS products feature
PHIFER WIRE PRODUCTS INC.

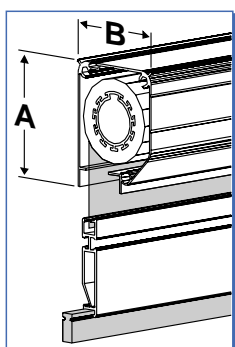

code 01-00310-
Case with tube, mesh in height 175 cm and sliding bar with pile

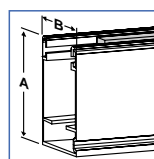

code 01-02050-
Guide with pile
A 30 mm. B 22 mm. (6 lin.mtrs.)

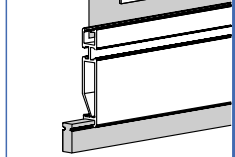

code 01-00320-
Case with tube, mesh in height 240 cm and sliding bar with pile
A 51 mm. B 41 mm. (6 lin.mtrs.)

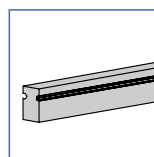

code 00-02010-
Pile for case
only for inset mounting (1000 lin.mtrs.)

Accessory kit* for inset
and front mounting
code 01-03720- short spring
code 01-03730- long spring

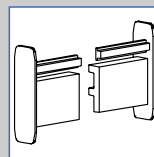

Sliding bar ends
(1 pc. L + 1 pc. R)

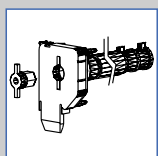

End cap with spring + cap
(1 pc.)

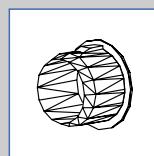

Bush
(1 pc.)

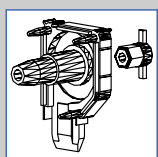

Single end cap + cap
(1 pc.)

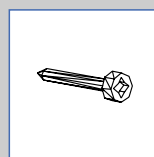

Little screw
(2 pcs.)

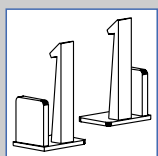

Internal locks
(1 pc. L + 1 pc. R)

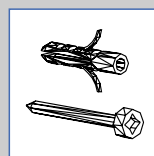

Screws and dowels
for inset mounting (4 pcs.)

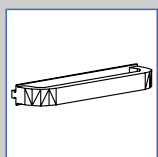

Handle
(2 pcs.)

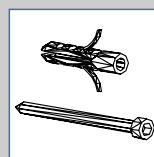

Screws and dowels
for front mounting (4 pcs.)

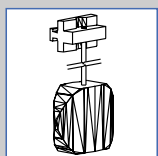

Acorn
(1 pc.)

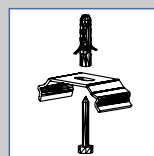

Fixing bracket
with screw and dowel (1 pc.)

Above listed data may change without notice.

*Kit available both in black and in white

system41

**USER-FRIENDLY
AND FUNCTIONAL**

41 mm RETRACTABLE INSECT SCREEN

SINGLE & DOUBLE HORIZONTAL (DOOR)



GENIUS products feature
PHIFER WIRE PRODUCTS INC.

The accessory kit includes all necessary components to assemble a Single or Double Roller Screen Door. Inset mounted or Front mounted options are possible.

Single & Double Horizontal (Door) Basic Profiles

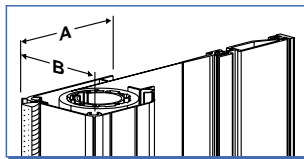

code 01-00482-
Cassette with tube,
mesh 175cm height
and Sliding Bar
A 51 mm. B 41 mm.

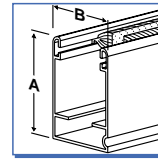

code 01-02090-
Top Guide with pile
A 30 mm. B 22 mm.

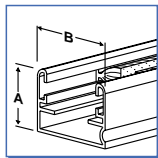

code 01-02070-
Bottom Guide with pile
A 15 mm. B 22 mm.

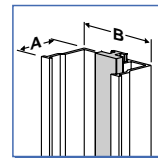

code 01-06120-
Side Profile
with magnets
A 14 mm. B 25 mm.
(Single Hoz. only)

- single door: 1 kit **code 01-04061-**
- double door: 2 kits **code 01-04061-**
+ Sliding Bolt Lock kit **code 01-23190-**
+ Magnets (Positive) **code 01-16000-0-5**
(Negative) **code 01-16010-0-5**

Accessory kit **code 01-04061-**

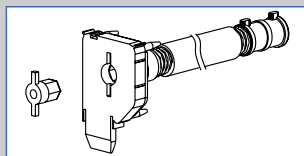

End Cap with spring
+ bush + cap
(1 pc.)

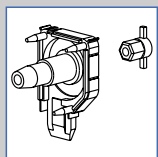

Plain End
Cap + cap
(1 pc.)

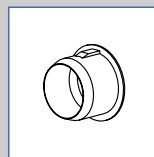

Bush for
plain
end cap
(1 pc.)

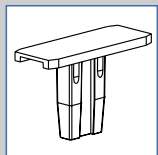

Sliding Bar
End Cap
(2 pcs.)

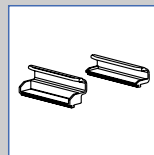

Handles
Inner
& Outer
(2 pcs.)

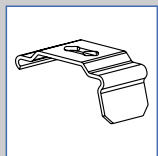

Fixing Bracket
Inset Mounting
(1 pc.)

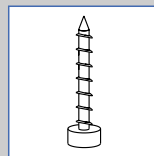

Fixing
Screws

Lock Bolt kit **code 01-23190-**

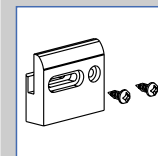

Top Guide
Lock Keep + screws
(1 pc.)

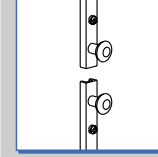

Lock Bolt
Assembly

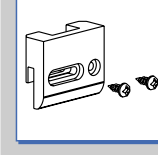

Bottom
Guide Lock
Keep + screws
(1 pc.)

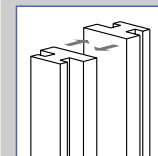

Magnetic Strips
Positive/Negative
01-16000-0-5 (1 pc.)
01-16010-0-5 (1 pc.)

Additional accessories for front fix option

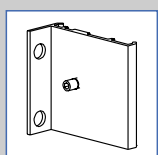

code 01-26100-
Aluminium
Angle bracket

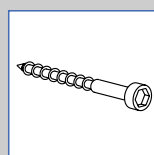

code 00-13140-0-0
Long Screw

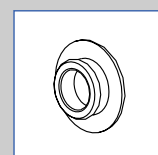

code 00-13050-
Plastic Cover
Cap

Above listed data may change without notice.

Libr. Syt41 ING V.1.0 0802 • PDF

GCZ-003E/0