

# Araknis

CASEMENT DOOR SCREEN

**QUICK  
AND EASY!**

# Araknis

CASEMENT DOOR SCREEN

**QUICK  
AND EASY!**

## ONE WING DOOR

### technical data

**Araknis** casement door screen is an aluminium frame known all over Europe as a most practical, versatile and effective screen door.

**With only four basic profiles**, it is possible to assemble in a short time a cut-to-measure door that will perfectly meet your needs.

No matter how big the opening you need to protect, you can find the right solution.

Assembly is quite easy and simplified by 90° cuts.

You can choose the configuration of wings, if they are to be opened in or outwards and in the one and two wing screens you can also have the door check option.

Nylon parts such as frame corners, match the profiles colours in order not to alter the aesthetics of the entrance.

**Araknis** is also available in a pre-cut kit form in a certain combination of

width and height for each style of wing configuration.



**Genius**  
www.geniusnetwork.biz

## COMPONENTS AND ACCESSORIES

The accessory kit code **03-03000-0** includes all the necessary components to assemble a one wing Araknis door.

GENIUS products feature  
**PHIFER** WIRE PRODUCTS INC.

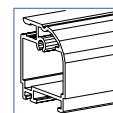

**code 03-00000**  
Door profile 28 x 30 mm.  
(5 lin. mtrs.)

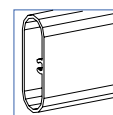

**code 03-00040**  
Reinforcing profile  
14 x 38 mm. (5 lin. mtrs.)

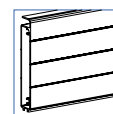

**code 03-00060**  
Bottom band profile  
15 x 83 mm. (5 lin. mtrs.)

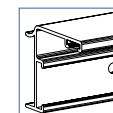

**code 03-01000**  
Frame profile  
32.5 x 36 mm. (5 lin. mtrs.)

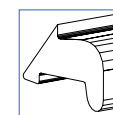

**code 03-00010-0/30-0**  
PVC Spline profile  
for fiberglass mesh (1.0/2.5 lin. mtrs.)  
**Option code 03-00050-0.** Rubber spline  
for aluminium or steel meshes.

### 1 wing door accessory kit code 03-03000-0

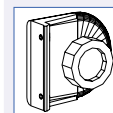

**code 03-13030-0**  
Handle  
(1 pc.)

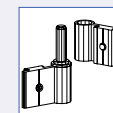

**code 03-13000**  
Complete hinge  
(3 pcs.)

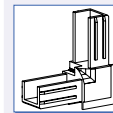

**code 03-13070-0**  
Square joint  
(2 pcs.)

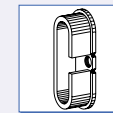

**code 03-13080-0**  
Reinforcing profile cap  
(2 pcs.)

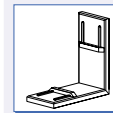

**code 03-13050-0**  
Joint cover plate  
(2 pcs.)

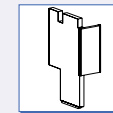

**code 03-13020-0**  
Frame insert  
(1 pair L/R)

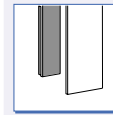

**code 03-13040-0**  
Magnetic strip + steel  
tape (2.5 lin. mtrs.)  
(1 pc. each)

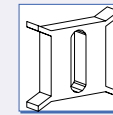

**code 03-13010-0**  
Screw insert  
(8 pcs.)

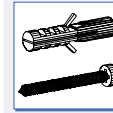

**code 00-13010-0**  
Screws and dowels (8 pcs.)

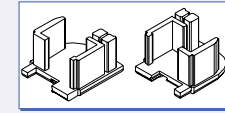

**code 03-13130-0**  
Bottom end caps  
(1 pair L/R)

## COLOURS AVAILABLE



Anodised  
Silver 0030



Anodised  
Bronze 0040



White  
RAL 9010



White  
RAL 1013



Black  
RAL 9005



Brown  
RAL 8014

Please, check the above colours on a RAL palette.

Above listed data may change without notice.

# Araknis

CASEMENT DOOR SCREEN

## ONE WING DOOR

### Maximum sizes recommended:

We suggest the maximum size of 100cm width x 250cm height. For larger doors go to the two, three or four wing model.

### Standard mesh and options:

Araknis is supplied with standard fibreglass mesh (code 00-00000-4) Optional aluminium (code 00-00010-4) and steel mesh (code 00-00020-4) are also available upon request.

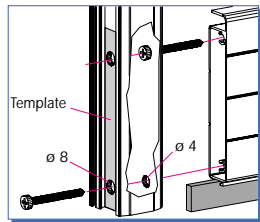

### IMPORTANT

- Holes to fix the bottom band code **03-00060-X-X** onto wing profile code **03-00000-X-X** are already pre-punched **ONLY** if you are using a complete kit. Be sure then to cut the vertical wing profiles at the end that is not pre-punched.
- If using bars, you can drill the holes by using a template matching the holes in the bottom band profile.

**Remember** to drill **FIRST** with a  $\varnothing$  4mm bit and to enlarge the hole with a  $\varnothing$  8mm bit, to let the screw head through, from the side **opposite** to the bottom band. This enables tight fixing. More than one bottom band can be used for additional kick height and door strength.

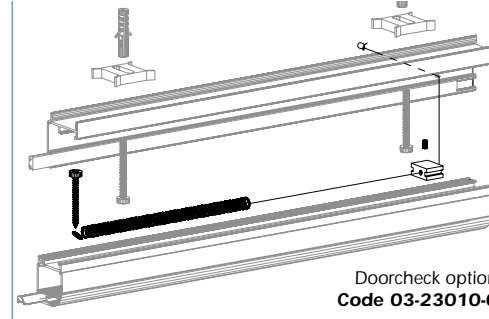

Doorcheck option  
Code 03-23010-0

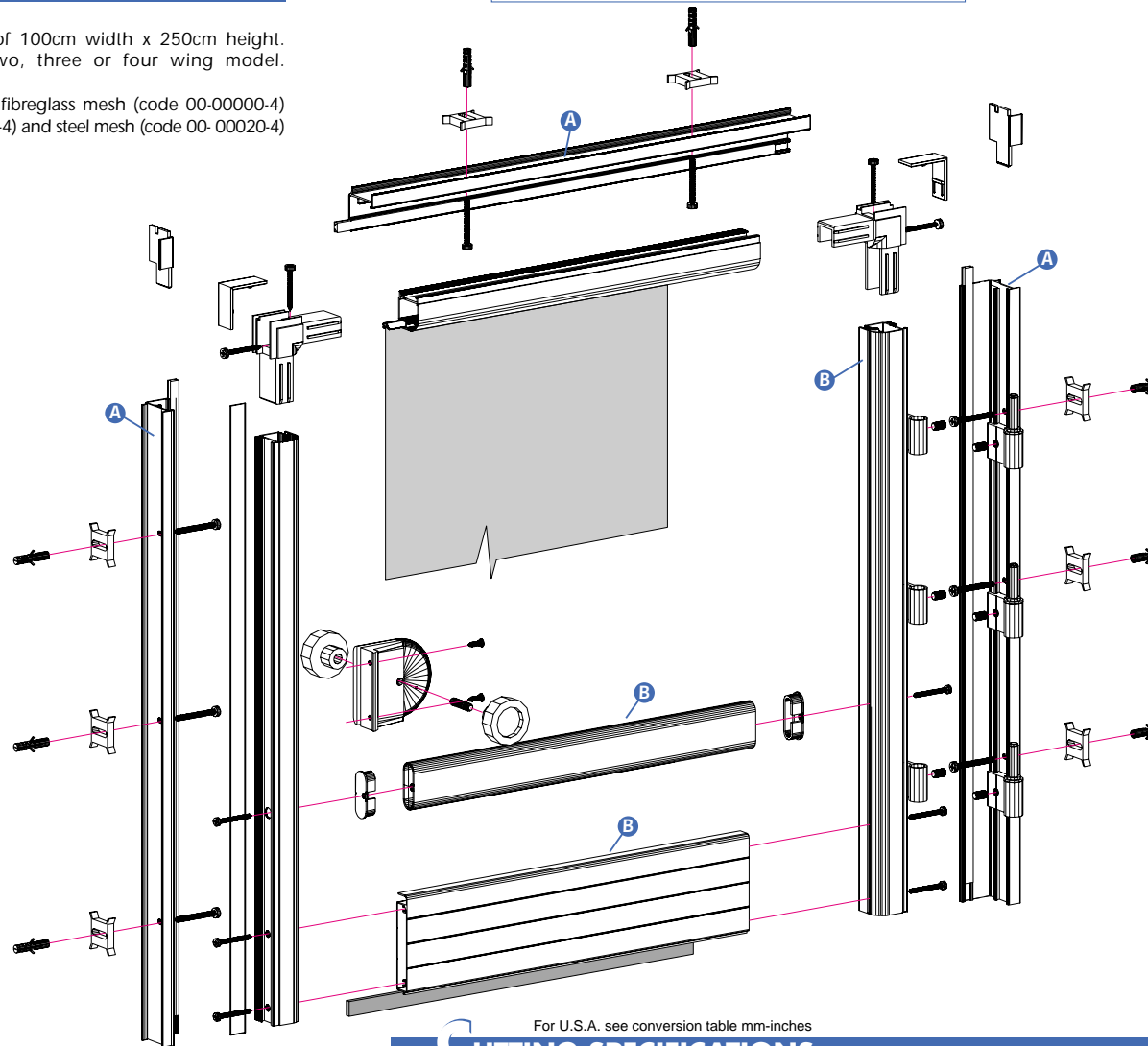

For U.S.A. see conversion table mm-inches

## CUTTING SPECIFICATIONS

### A outer frame:

horizontal outer frame profile: = opening width **exact** 1 Pc.  
vertical outer frame profile: = opening height **minus 36 mm** 2 Pcs.

### B wing profiles:

horizontal door profile: = opening width **minus 93 mm** 1 Pc.  
vertical door profile: = opening height **minus 57 mm** 2 Pcs.  
bottom band profile: = opening width **minus 93 mm** 1 Pc.  
reinforcing profile: = inner width of the vertical door profiles **minus 3 mm** 1 Pc.

## SUGGESTIONS

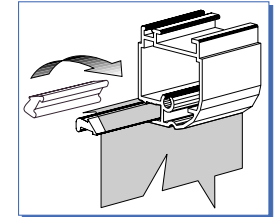

How to insert the PVC spline (for fibreglass) into the profile groove.  
(Use a plastic mallet in good condition)

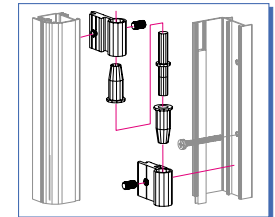

How to assemble the various components of the hinge.

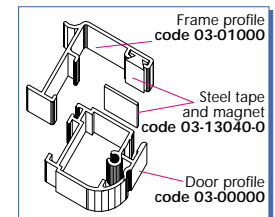

How to fix magnet and steel tape onto the frame profile and onto the closing profile respectively.

**Genius**<sup>®</sup>

www.geniusnetwork.biz